

The Enclave at 67th

NOW SELLING!

Welcome to The Enclave at 67th! This brand-new community is located on 67th Ave North and only minutes from the beach, golf courses, restaurants, shopping plazas, and attractions. New homes in this community offer 2-story floor plans, featuring spacious living areas, functional loft spaces and first floor guest suites.

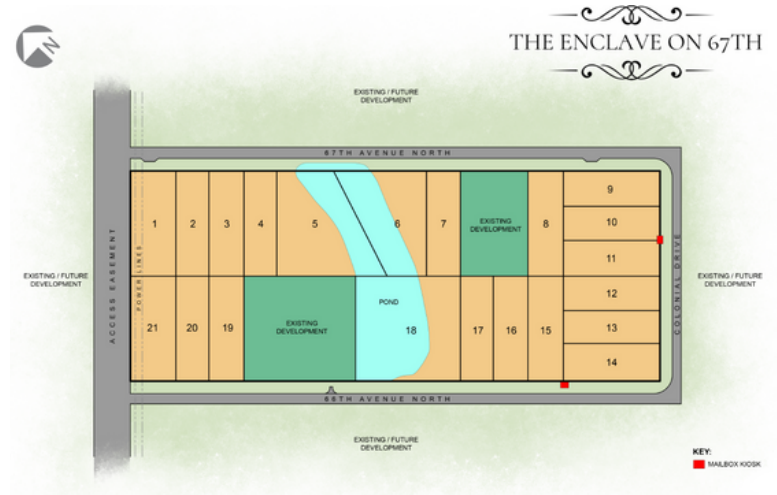

Scan to join our First-to-Know List!



Receive exclusive floorplan and grand opening information.

For more information contact us:
843-485-0688 | MyrtleBeachInfo@drhorton.com

D.R. Horton is equal housing opportunity builder. Home and community information, including pricing, included features, terms, availability and amenities, are subject to change and prior sale at any time without notice or obligation. Pictures, photographs, features, colors and sizes are approximate for illustration purposes only and will vary from the homes as built. Square footage dimensions are approximate.



The Enclave at 67th

Areas of Interest

- 0.8 miles to the beach
- 1.2 miles to Highway 31
- 1.8 miles to local grocery stores
- 2.1 miles to the Grand Strand Medical center and doctor offices
- 2.5 miles to golf courses
- 4.7 miles to Tanger Outlets
- 5.0 miles to the Myrtle Beach Boardwalk and Promenade
- Minutes from local restaurants, shopping centers, and attractions
- 6.9 miles to Barefoot Landing
- 9.0 miles to Myrtle Beach International Airport



D.R. Horton is equal housing opportunity builder. Home and community information, including pricing, included features, terms, availability and amenities, are subject to change and prior sale at any time without notice or obligation. Pictures, photographs, features, colors and sizes are approximate for illustration purposes only and will vary from the homes as built. Square footage dimensions are approximate.